

COAXIAL

XP5X

- 1 Surround in gomma.
- 2 Gasket in ABS per iniezione.
- 3 Cono in cellulosa trattata.
- 4 Trecciole argentate.
- 5 Tweeter al neodimio.
- 6 Terminali placcati oro 4,8x7,2 mm.
- 7 Cestello a norme DIN in lamiera con trattamento anti-corrosivo.

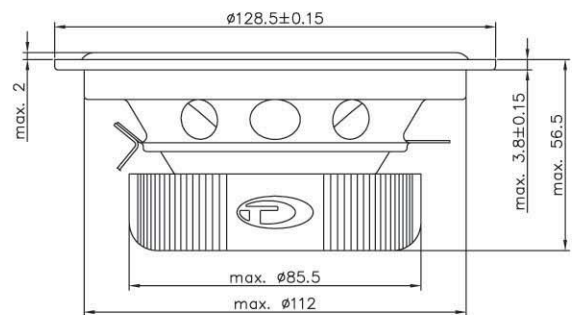
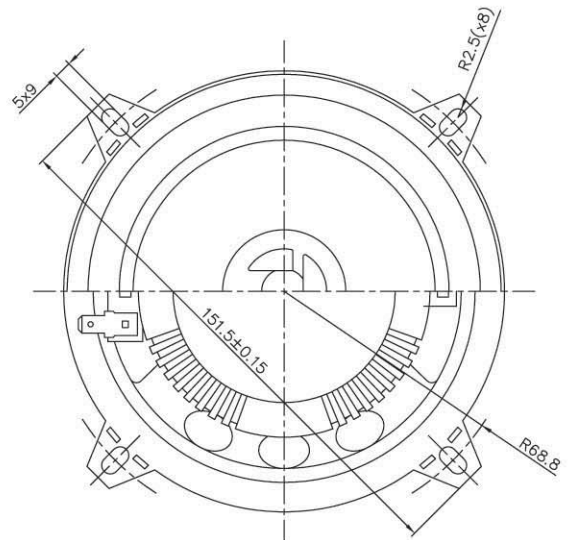

Frequency range	Hz	85-20000		
			T_w	W
Equivalent volume, Vas	L	0.001		8
Compliance, Cms	mm/N	0.04		0.92
Mechanical resistance, Rms	Ns/m	--		1.24
Effective diaphragm/cone area, Sd	cm ²	4.9		85
Voice coil diameter	mm	13		25
Voice coil height	mm	1.5		10
Air gap height	mm	2		4
Linear excursion, Xmax	mm	--		±3
Max mechanical excursion	mm	--		±4
Nominal impedance	ohm	4		4
Voice coil resistance	ohm	3.1		3.1
Voice coil inductance	mH	0.03		0.27
Free air resonance, Fs	Hz	2000		80
Sensitivity, Spl (2.83V/1m)	dB	90		89
Force factor, Bxl	Tm	--		2.7
Moving mass, Md	g	0.2		4.6
Qms	--	--		3.20
Qes	--	--		1.21
Qts	--	--		0.88
Nominal power	W	25		45
Short term max power	W	80		200
Long term max power	W	40		100
Total weight of driver	g	23		673

